

Quick Start Guide

Factory Reset & Calibration

PART 1 — Connect GlassOuse to the App

■ **Note:** Before starting, make sure your GlassOuse PRO / Link is connected to your phone via **Bluetooth** — the same phone on which the GlassOuse app is installed.

STEP 1 Open the App & Connect

Open the GlassOuse app. On the home screen, tap the **Connect Now** toggle in the top-right corner.

Tip: Ensure GlassOuse PRO is powered on and Bluetooth is enabled.

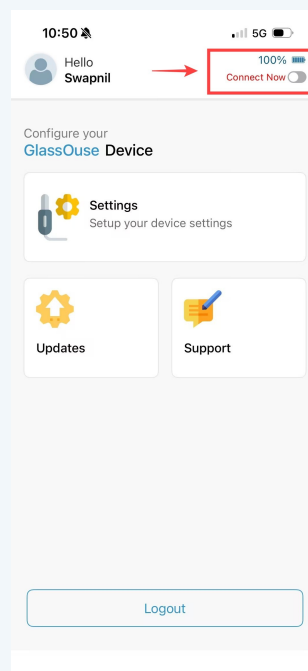

STEP 2 Select Your Device

On the **Device Select** screen, tap **Connect Now** next to your GlassOuse PRO.

Tip: Your device name and UUID will appear once detected.

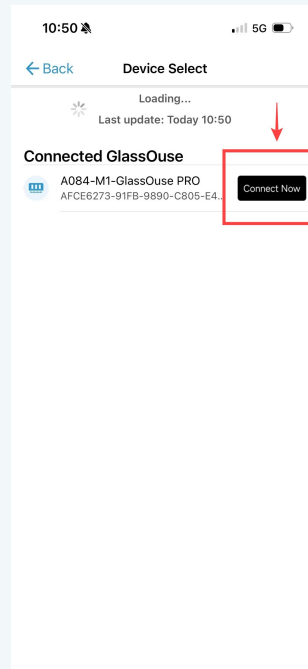

PART 2 — Factory Reset & Calibrate

STEP 3 Open Settings

Once connected (toggle turns blue), tap the **Settings** tile on the home screen.

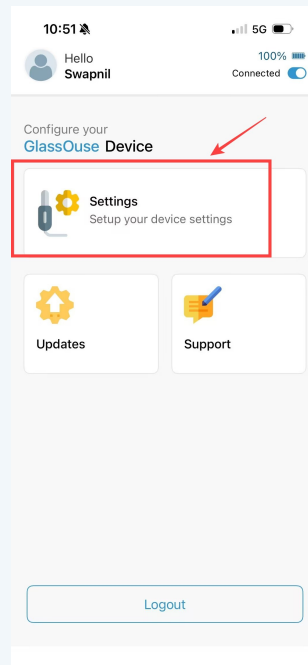

STEP 4 Factory Reset

Tap **Reset to Factory Settings** and confirm. This clears all custom configurations.

Tip: Always reset BEFORE calibrating.

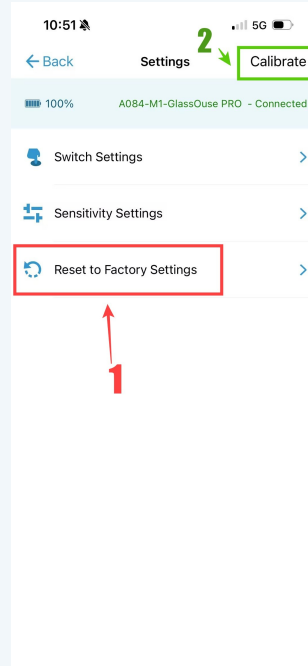

STEP 5 Calibrate

Tap **Calibrate** (top-right of Settings). Place GlassOuse PRO flat with the **USB-C port facing upward**, then tap **CONFIRM**.

Tip: Keep the device perfectly still during calibration.

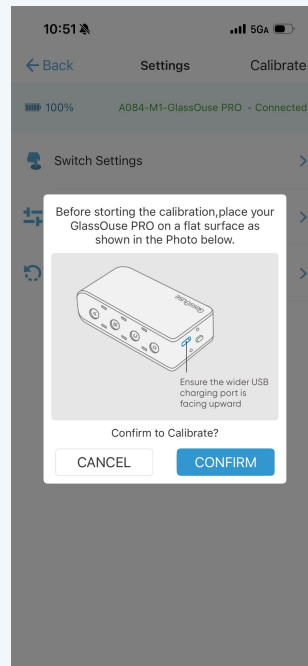

GlassOuse PRO is now reset and calibrated. Return to Settings to configure Switch Settings and Sensitivity.